

Threaded End Connection

Series US Carbon Steel Meter Valve

- Lever Operated Ball Valve
- 175 PSI WP
- 3/4" and 1"
- Welded Body Construction
- 100% Made in USA
- Individually Tested and Stamped to ASME B16.33
- Full Port to Accommodate Industry Stop Changers
- Designed for Decades of Maintenance Free Service
- Does Not Require Grease or Periodic Adjustments
- Certified Low Emission Per API 641
- Fire Safe Design
- Forged steel Body
- Fully welded construction
- Multi-Seal Seats
- Redundant Seals Throughout
- Tamper Resistant Lock Nut

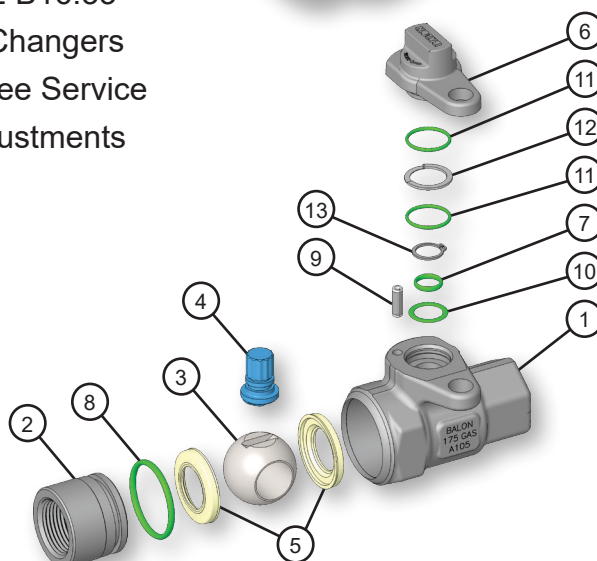

Material Description

ITEM	PART NAME	MATERIAL NACE (STANDARD)
1	Body	ASTM A105, Normalized
2	Adapter	ASTM A108 1018
3	Ball	Carbon Steel Nickel Chrome Plated
4	Stem	316 Stainless Steel
5	Seat	Polyketone
6	Drive Nut	Zinc Alloy
7	O-Ring	Fluorocarbon
8	O-Ring	Fluorocarbon
9	Stop Pin	316 Stainless Steel
10	O-Ring	Fluorocarbon
11	O-Ring	Fluorocarbon
12	Retaining Ring	Stainless Steel
13	Retaining Ring	Carbon Steel

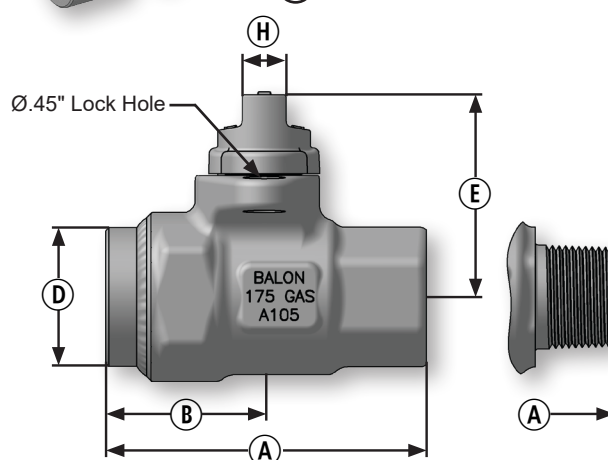

Dimensional Data

SIZE	CATALOG NUMBER	PORT	WP	A	B	D	E	H	LBS.
	STANDARD TRIM BALL & STEM								
.75x.75x.75	3/4F-US175-FF	.75	175	3.51	1.71	1.82	2.10	0.48	1.7
.75x.75x.75	3/4F-US175-MF	.75	175	3.51	1.71	1.82	2.10	0.48	1.62
1x1x1	1F-US175-FF	1	175	3.90	1.94	1.86	2.40	0.48	2.7
1x1x1	1F-US175-MF	1	175	3.90	1.94	1.86	2.40	0.48	2.5